

# **GAMA SONIC®**

## **SOLAR LIGHTING**

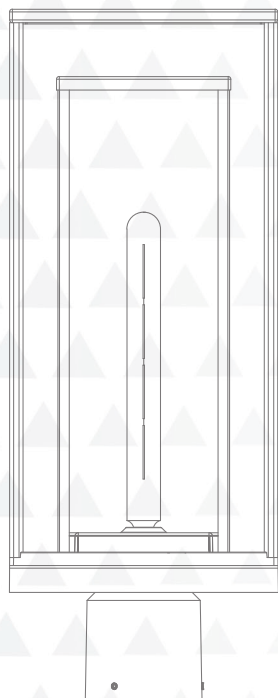

**3" FITTER**

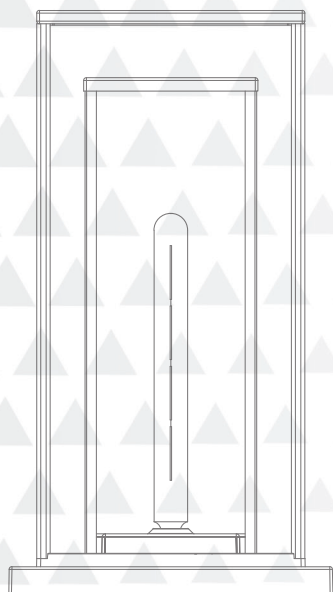

**PIER/ACCENT**



## **NOVAEDGE SOLAR LIGHT**

Part #: 64B50011, 64B50012

 Please read the instruction manual carefully to obtain the best results from your purchase.

Thank you for your purchase! GAMA SONIC® solar charged lights are brighter and last all night with a typical solar charge. Unique design, superior light output and numerous installation options confirm the outstanding value of our product. GAMA SONIC® has been recognized as a worldwide leader in the lighting industry for over 20 years.

**Technical Assistance/Warranty Claims/Replacement Parts**  
**Toll Free Number: +1-800-835-4113 (only within the US) or [www.gamasonic.com](http://www.gamasonic.com)**

**Visit our website or download the latest version of your instruction manual:**  
**[www.gamasonic.com](http://www.gamasonic.com)**



## Solar Lamp Location

For optimum light duration throughout the night, it is very important to mount your solar lamp in a spot where it will receive the maximum amount of direct sunlight throughout the day

For best results, the solar light must be charged in the "ON" (High or Low) position for at least 2 days of full direct sunlight.

## What's In The Box

A = Light Fixture      D = 3" Fitter Mount (64B50012)  
B = Battery              E = Pier Base Cover (64B50011)  
Compartment          F = Bulb  
C = Base

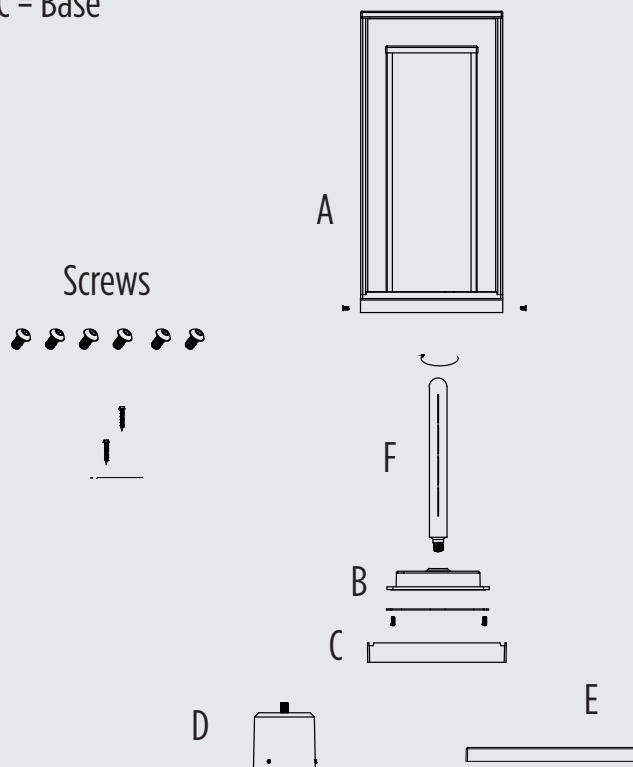

## Assembly Instructions

- Place the light fixture gently upside down, resting on the solar panel. Ensure the panel is on a stable, non-abrasive surface to prevent damage.
- Locate the two screws on the side of the fixture and unscrew them then carefully push out the corners of the base (C) to detach it from the fixture.
- Disconnect the internal wiring by gently unplugging the connector.
- Unscrew the six screws securing the battery compartment (B) and lift it out
- Install the light bulb in the socket and twist it clockwise.

**NOTE: Make sure to grip the light bulb by the base only and NOT the glass**

- Place the battery compartment (B) back into position and secure it by tightening the six screws.

**NOTE: Do not over-tighten the screws.**

- Reconnect the wire to restore power.
- Follow the operation instructions to turn on the lamp and select the desired setting.
- Reattach the base (C) and secure it with the two side screws removed in Step 2.

### For Pier/Accent Mount Installation:

- Slide the additional pier base cover (E) over the fixture until it is securely in place.

### For 3" Fitter Mount Installation:

- Install the 3" Fitter (D) to the fixture by twisting it clockwise onto the threaded rod. Make sure it is fastened securely.
- Install the lamp on your existing 3" post and secure it by tightening the set screws. Do not over-tighten the set screws.

**NOTE: If you are replacing an existing gas/electric post light, you must consult a certified technician to disconnect it before installation.**

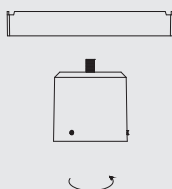
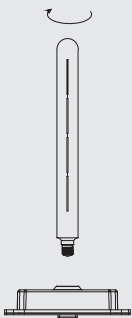
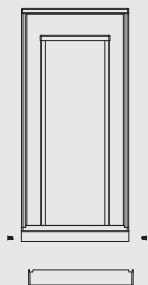

## Operation Instructions

- Place the light fixture upside down on a stable surface, protecting the solar panel. Unscrew and remove the base (C)
- Move the operation switch to the High or Low position according to your preferences:
  - Low** = softer light, longer duration
  - High** = brighter light output
- Reattach the base and secure it with the screws
- Your lamp will turn on automatically at dusk.

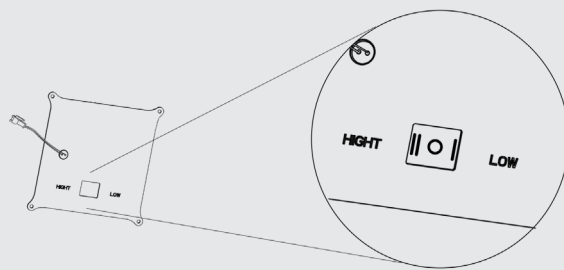

## Replacement Parts

Replacement Batteries and Bulbs are available at [www.gamasonic.com](http://www.gamasonic.com) or via our Toll Free number: +1-800-835-4113.

Your lamp uses the following Bulb:

T20LWW04W - included bulb with Warm White LEDs (2700K)

Your lamp uses the following battery:

GS32V30



## Replacing the Batteries

**GAMA SONIC®**  
SOLAR LIGHTING

**After several years of use, the battery may need replacing.**

1. Locate the two screws on the side of the fixture and unscrew them then carefully push out the corners of the base (C) to detach it from the fixture.
2. Switch the unit to the OFF position.
3. Disconnect the internal wiring by gently unplugging the connector.
4. Unscrew the six screws securing the battery compartment and lift out only the lid cover
5. Make sure the new battery is a high-quality Li-Ion battery with matching connector, Part# GS32V30.
6. Clip in the new battery and install the battery in the compartment.
7. Reassemble the lamp by reversing steps 1-4

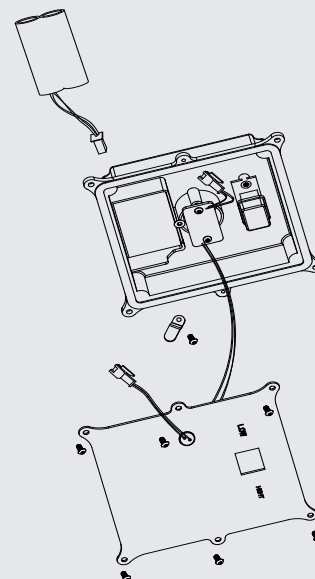

**Batteries are available for purchase at [www.gamasonic.com](http://www.gamasonic.com)**

## MAINTENANCE

Clean the solar panels regularly with a damp towel to guarantee optimum performance. Do not use any type of solvent for cleaning and be careful not to put too much pressure on the solar panels while cleaning.

## TROUBLESHOOTING

If your solar light does not come on as expected despite observance of all the instructions, please try the following steps:

1. Make sure that the solar lamp is not being affected by any other light source.
2. Ensure the solar lamp is not positioned in the shade during the day.
3. Check that the batteries are installed correctly.

NOTE: The performance of the solar lamp will vary with the time of year. It will last longer when it has had a full day in the sun rather than a day in overcast weather.



**WINTERTIME TIPS:** For optimal performance, be sure to remove any snow or debris accumulation from solar panel(s). A solar panel free of debris will charge the batteries much more efficiently.



**WARNING:** Please keep out of reach of children. Do not dispose of Li-Ion battery in the regular trash, municipal waste stream or by fire as batteries may leak or explode. Do not open, short circuit, or mutilate batteries as injury may occur. Preserve our environment by recycling Li-Ion batteries or disposing of them in accordance with local, state and federal regulations. Do not mix old and new batteries.

